

TW 系列过滤减压阀 - 基本型



● TW2000-02 ● TW2000-02U ● TW4000-04

● 特性

过滤、减压一体化设计，产品体积小、结构合理、节省安装空间，既能为气动系统提供清洁干燥的气源，又能保证气源的稳定压力。

● Ordering Code

TW	2000	02	U
Series	Type	Pipe size	Iron Shell
	1000	M5	No Mark ;
	2000	01 : G1/8	2000 No Iron Shell
	3000	02 : G1/4	3000 ~ 5000 With Iron Shell
	4000	03 : G3/8	U:2000 With Iron Shell
	5000	04 : G1/2	
		06 : G3/4	
		10 : G1	

■ Graphics Sign

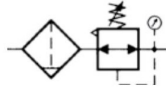

■ Technical Parameter

Specification	TW1000-M5	TW2000-02/01	TW3000-03/02	TW4000-04/03	TW4000-06	TW5000-10/06
Applicable Medium	Air					
Rating Flow(L/min)	100	550	2000	4000	4000	5000
Filtration	5 μm ~ 40 μm					
Applicable Pressure Range	0.05 ~ 0.7MPa	0.05 ~ 1MPa				
Medium Temperature	0 ~ 60°C					
Type of Valve	Relief Type					
Gauge Port Size	G1/16	G1/8		G1/4		

■ Figure Dimension

● TW1000-M5
TW2000-02/01

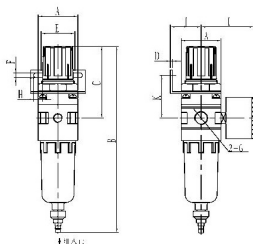

● TW3000-03/02 TW4000-04/03
TW4000-06

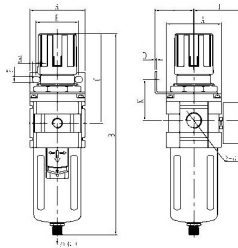

● TW5000-10/06

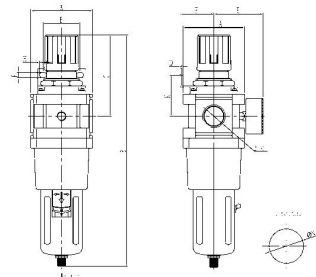

TW2000-5000: 最大行程3.5
TW1000-5000: 最大行程5

Type	A	B	C	D	E	F	G	H	I	J	K	N
TW1000-M5	25	115	50	2.0	28	4.5	M5	6.5	26	25	30	20.5
TW2000-02/01	40	188	72.5	2.0	34	5.5	G1/4	15	53	31	43	41.5
TW3000-03/02	53	216	89	2.0	54	6.5	G3/8	8	56	48	50	42.5
TW4000-04/03	70	256	114	2.0	54	8.5	G1/2	10.5	62	50	52	52.5
TW4000-06	75	256	114	2.0	54	8.5	G3/4	10.5	62	50	52	52.5
TW5000-10/06	90	337	118	3.0	54	8.5	G1	11	78	60	60	52.5