

Flange End Ball Valve Full Port ISO-5211 Mounting Pad

2-pc Design



Features:

- Full Port
- Class 150/ Class 300
- Fire-Design Upon Requirement Acc.API607
- Blow-Out Proof Stem
- Blance Hole in Ball Slot
- V-Ring Packing for Self-Adjustment
- ◆ & ■ Stem For Customer Requirement
- Design Standard:ASME B16.34
- Face to Face:ASME B16.10
- Testing Standard:API 598/SP-110

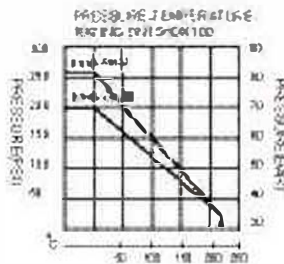
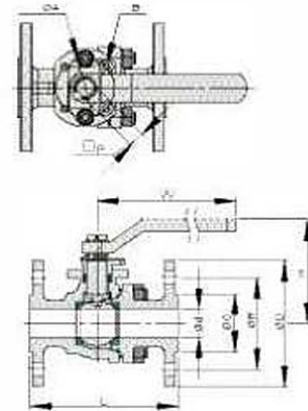

PRESSURE TESTING

STANDARD PRESSURE	1.6Mpa
SHELL PRESSURE TESTING	2.4Mpa
WATER SEAL TESTING	1.8Mpa
AIR SEAL TESTING	0.4-0.7Mpa

WR-270

150LB/10K
DIMENSION

(unit mm)

SIZE	Φd	L	H	W	ΦC	ΦR	ΦD	N-M	P	A	B	TORQUE N.M	CV
DN15	15	108	94	125	34.9	60.3	90	4-16	9	42	5	5	3.4
DN20	20	117	97	125	42.9	69.9	100	4-16	9	42	5	7	7
DN25	25	127	106	156	50.8	79.4	110	4-16	11	60	5	8	12.4
DN32	32	140	150	156	63.5	88.9	115	4-16	11	60	5	15	20.3
DN40	38	166	127	190	73	88.4	125	4-16	14	70	6	22	28.5
DN50	50	178	137	230	92.1	120.7	150	4-19	14	70	6	25	47.5
DN65	65	90	158	230	104.6	139.7	160	4-19	17	102	6.5	50	76
DN80	80	203	178	265	127	152.4	190	4-19	19	102	8	85	108.4
DN100	100	229	204	290	157.2	190.5	230	4-19	19	102	8	115	198

DRAWING

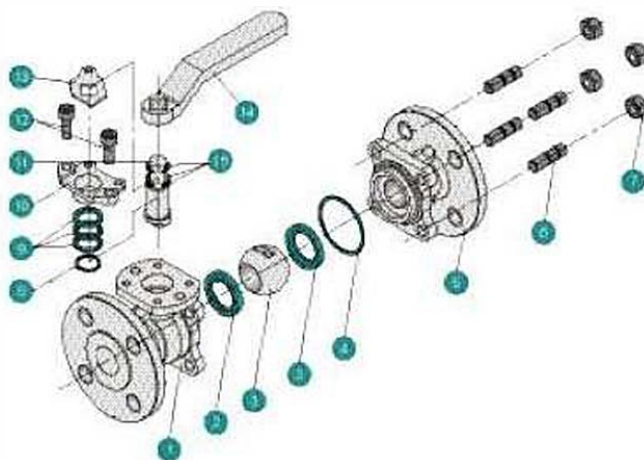

MATERIAL LIST

ITEM	PART NAME	MATERIAL
1	BODY	CF8M CF8 WCB
2	BALL SEAT	PTFE R-PTFE
3	BALL	SUS316 SUS304
4	BODY GASKET	PTFE
5	CAP	CF8M CF8 WCB
6	BOLT	SUS304
7	NUT	SUS304
8	THRUST WASHER	PTFE
9	V-RING PACKING	PTFE
10	STOP CAP	CF8M CF8
11	STEM	SUS316 SUS304
12	BOLT	SUS304
13	POSITION WASHER	SUS304
14	HANDLE	CF8
15	LOCKING WASHER	SUS301