

SINTEK

RPA Series Acrylic Flow Meter

Oxygen bar flowmeter description

Oxygen bar flowmeter is a kind of flow meter with plexiglass as the main body, used to measure the single phase of liquid or gas non-pulsating flow rate. It is characterized by beautiful appearance; Light weight; Not easily broken; Long service life.

RPA-6T O2 oxygen bar flowmeter The flowmeter is widely used in medical equipment, oxygen generator



RPA-6T O2 series flowmeter dimensions

Model	No.	Range of measurement (L/min)	Mode of connection	Precision	Size (mm)							
					A	B	C	D	ε	F	G	H
RPA-6T O ₂	1	1-3	Hose connection	±5%	60	20	21or19	40	M10X1 or 9/16-18	8	22	8
	2	1-5			70	20		50		7	22	7
	3	0-5 0-9 0-10			93	20		70		10	22	8
	4	1-5 0-6			96	20		70		13	22	8
	5	0-5 1-5 0.1-1 2-10 0.5-10 0.5-14 4-25 0-1000cc/min			106	20		80		13	22	8
	6	1-5 0.5-10 2-10			108	20		70		25	22	8
	7	0-5 1-5 2-10 0.5-14			115.5	20		90		13	22	8

RPA-6T O2 series flowmeter parts material and code

There is or not regulating valve	Material of regulating valve	Contact resistance material	O-ring material
T- With regulating valve	1. Brass	1. Brass	1. Fluorin rubber
O- No regulating valve	2. Stainless steel	2. Brass chrome plating 3. Stainless steel 4. Plastic	2. Epdm rubber

SINTEK

Oxygen bar flowmeter connection diagram

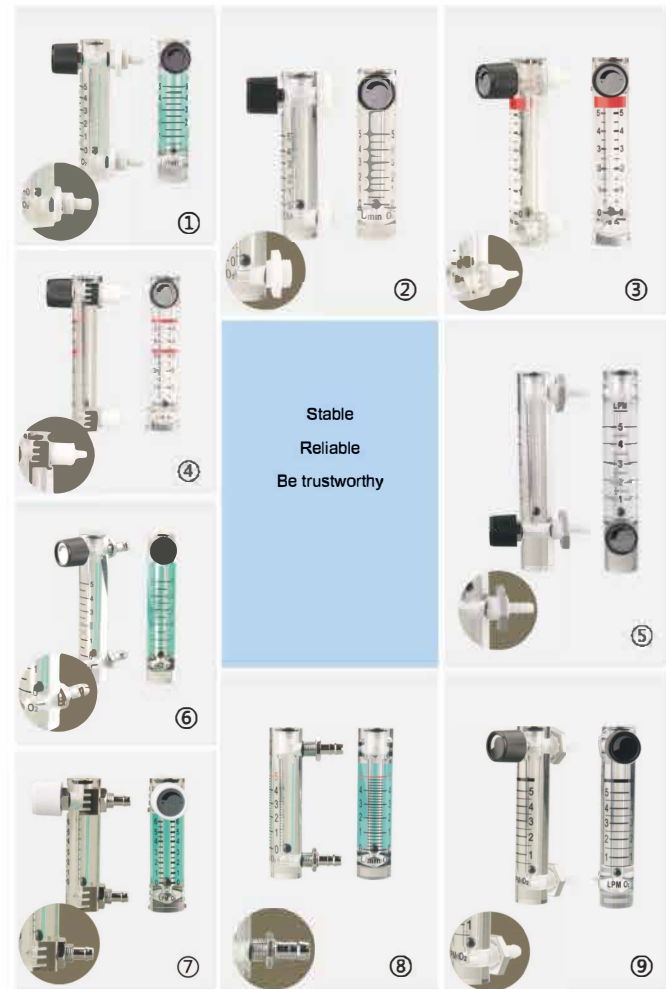

SINTEK

RPA Series Acrylic Flow Meter

RPA-4T, 6T, 8T Series plexiglass flowmeter

Overall dimensions (with valve)

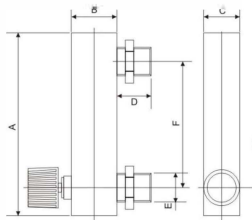

Overall dimensions (without valve)

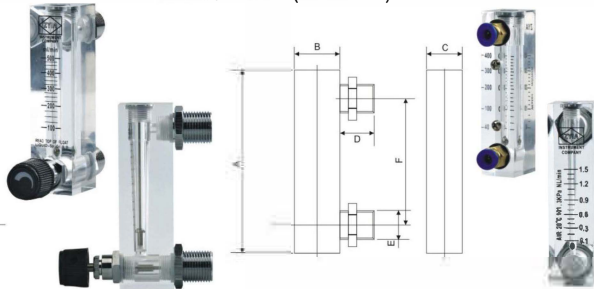

RPA-4T, 6T, 8T Series surface plate flowmeter technical parameters

Model	Range of measurement				Interface screw thread	Precision	Condition of the medium under test		Size (mm)						
	MI/min (liquid)	L/min (gas)					Tem °C	Pres Mpa	A	B	C	D	E	F	
RPA-4T	6-60 8-80 30-120 40-400	0.05-0.5 0.25-2.5 1-5	0.1-1 0.6-6 1-10	0.2-2 1-4 1-12	6mm quick-plug connection				94	27	21	14	14	70	
RPA-6T	6-60 10-70GPH 16-160 25-250 60-400 100-500 100-600 200-800 100-1000	0.1-0.8 0.3-3 1-5 2-20 4-20 10-60 0.05-0.25m³/h 0.04-0.4 m³/h	0.1-1.5 0.4-4 1-12 3-15 5-25 10-70	0.1-1 0.5-8 2-10 3-30 6-30 10-100	in G1/4"	±4%	0-60	≤1	102	30	25	20	M18x1.5	77	
RPA-8T	2.5-25LPH 5-45LPH 6-60LPH	0.16-1.6 m³/h 0.1-1 m³/h 0.2-2 m³/h							110	25	25	20	M18x1.5	80	

RPA- 4T, 6T, 8T series surface plate flowmeter parts material and code

There is or not regulating valve	Material of regulating valve	Interface material	O-ring material
T- With regulating valve O- No regulating valve	√ Step 1: Brass 2. Stainless steel	1. Plastic ABS 2. Plastic PP 3. Plastic PVC 4. Brass √5. Brass chrome plating 6. Stainless steel	√ 1. Silicone ring 2. Fluorin rubber 3. Epdm rubber

Note: Check √ material for meter gauge configuration

SINTEK

RPA-Z Series Acrylic Flow Meter



RPA-Z Series surface plate flowmeter technical parameters

Stainless steel joint type

Model	Range of measurement			Interface screw thread	Precision	Condition of the medium under test		Size (mm)							
	GPM (liquid)	LPM (liquid)	Nm³/h (gas)			Tem °C	Pres Mpa	A	B	C	D	E	F	G	H
RPA-15ZA		15-150LPH	0.1-1 0.16-1.6 0.3-3 0.4-4	out ZG1/2" in ZG1/4"				157	32	150	35	25	60	25	110
RPA-15Z		10-100LPH 16-160LPH 25-250LPH	0.04-0.4 0.1-1 0.16-1.6 0.3-3 0.25-2.5 0.4-4	out ZG1/2" in ZG1/4"	±4%	0-60	≤1	175	32	168	35	25	76	25	127
		0.03-0.35	0.1-1.4												
		0.05-0.5	0.2-1.8												
		0.1-1	0.5-4												
		0.15-1.5	0.6-6												
		0.2-2	1-7												
RPA-25Z		0.3-3 0.5-5	1-11 2-18	out ZG1"	±4%	0-60	≤1	234	45	226	46	33	100	37	160
		1-10	5-35												
		1-15	5-50												
		2-14	10-50												
		2-20	10-70												
		5-35	10-130												
	5-40	10-150													
	5-45	10-170	2.5-15 2.5-25 4-40 6-60 10-100 20-100 16-160 25-250 30-300 35-350												
		0.3-2.1 m³/h 0.6-3 m³/h 0.6-4.2 m³/h													

RPA- Z

Interface material	O-ring material
1. Plastic ABS √ 2. Plastic PP 3. Plastic PVC	4. Brass 5. Brass chrome plating 6. Stainless steel
	√ 1. Silicone ring 2. Fluorin rubber 3. Epdm rubber

Note: Check √ material for meter gauge configuration

RPA Series Acrylic Flow Meter

RPA-J Series surface plate flowmeter technical parameters

Model	Range of measurement			Interface screw thread	Precision	Condition of the medium under test		Size (mm)							
	GPM (liquid)	LPM (liquid)	Nm ³ /h (gas)			Tem °C	Pres Mpa	A	B	C	D	E	G	H	I
RPA-15J	0.1-1	0.5-4	1-10 1.6-16 2.5-25 4-40	out Z1/2" out G1/2"	±4%	0-60	≤1	216	32	206	37	33	1/2"	165	30
	0.2-2	0.8-8													
	0.3-3	1-11													
	0.5-5	2-18													
	1-7	2-28													
RPA-20J	1.5-9	400-2000LPH	2.5-25 6-60 16-80 16-160	out Z3/4" out G3/4"	±4%	0-60	≤1	233	39	220	44	49	3/4"	165	32
	2-10	8-40													
	2-16	8-60													
RPA-25J	2-20	8-80	20-200 25-250	out Z1" out G1"	±4%	0-60	≤1	253	44	240	50	48	1"	175	40
	1.5-15	6-60													
	3-13	10-50													
	4-24	10-100													
	5-35	10-130													
	5-45	20-170													

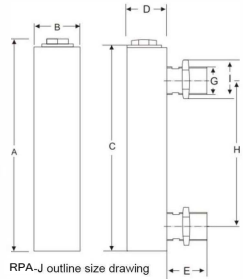

RPA-J Series surface plate flowmeter parts material and code

Interface material	Material of float	O-ring material
1. Plastic ABS	√1. Stainless steel	√1. Silicone ring
2. Plastic PP	2. Agate ball	2. Fluorin rubber
√3. Plastic PVC	3. Teflon	3. Epdm rubber
4. Brass		
5. Brass chrome plating		
6. Stainless steel		

Note: Check √ material for meter gauge configuration



RPA Series Acrylic Flow Meter

RPA- Series surface plate flowmeter technical parameters

Model	Range of measurement			Interface screw thread	Precision	Condition of the medium under test		Size (mm)							
	GPM (liquid)	LPM (liquid)	Nm ³ /h (gas)			Tem °C	Pres Mpa	A	B	C	D	E	F	G	H
RPA-15	0.1-1	0.5-4	1-10 1.6-16 2.5-25 4-40	out ZG1/2"	±4%	0-60	≤1	216	32	206	37	36	100	28	165
	0.2-2	0.8-8													
	0.3-3	1-11													
	0.5-5	2-18													
	1-7	2-28													
	1.5-9	400-2000LPH													
RPA-20	2-10	8-40	2.5-25 6-60 16-80 16-160	out ZG3/4"	±4%	0-60	≤1	233	39	220	44	42	100	37	165
	2-16	8-60													
	2-20	8-80													
RPA-25	1.5-15	6-60	20-200 25-250	out ZG1"	±4%	0-60	≤1	253	44	240	50	31	100	37	175
	3-13	10-50													
	4-24	10-100													
	5-35	10-130													
	5-45	20-170													
	10-45	40-170													
RPA-40	10-60	40-200	20-200 25-250	out ZG1 1/2"	±4%	0-60	≤1	265	62	250	62	33	100	52	170
	10-60	60-240													
	20-70	80-260													
	20-80	80-300													
	20-80	80-300													

RPA- Series surface plate flowmeter parts material and code

Interface material	O-ring material
1. Plastic ABS	√1. Silicone ring
2. Plastic PP	2. Fluorin rubber
√3. Plastic PVC	3. Epdm rubber
4. Brass	
5. Brass chrome plating	
6. Stainless steel	

RPA-25 interface material standard for PVC

Note: Check √ material for meter gauge configuration

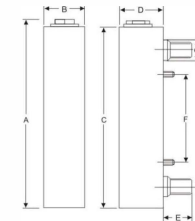

This style is fixed by screws



RPA Series Acrylic Flow Meter

RPA-ZT /T/JT Series surface plate flowmeter technical parameters

Model	Range of measurement			Interface screw thread	Precision	Condition of the medium under test	
	GPM (liquid)	LPM (liquid)	Nm ³ /h(gas)			Tem °C	Pres Mpa
RPA-15ZAT		15-150LPH	0.1-1 0.16-1.6 0.3-3 0.4-4				
RPA-15ZT		10-100LPH	0.04-0.4 0.16-1.6 0.1-1 0.25-2.5 0.3-3 0.4-4 0.6-6 0.8-8 1-10 1.6-16 2.5-25 4-40	out ZG1/2" in ZG1/4"	±4%	0-60	≤1
		16-160LPH					
		25-250LPH					
	0.1-1	0.5-4					
	0.2-2	1-7					
	0.3-3	1-11					
RPA-25ZT		10-50	20-100 35-350 40-160 50-250	out ZG1"	±4%	0-60	≤1
		6-20					
		10-35					
		10-40					
		15-45					
		30-150					
RPA-15T		0.1-1	1-10 1.6-16 2.5-25 4-40	out ZG1/2"	±4%	0-60	≤1
		0.2-2					
		0.3-3					
		0.5-5					
RPA-20T		2-10	2.5-25 6-60 16-80 16-160	out ZG3/4"	±4%	0-60	≤1
		2-20					
RPA-25T		3-13	2.5-25 6-60 16-80 16-160	out ZG1"	±4%	0-60	≤1
		6-24					
		10-35					
		10-45					
RPA-15JT		0.1-1	1-10 1.6-16 2.5-25 4-40	out Z1/2" out G1/2"	±4%	0-60	≤1
		0.2-2					
		0.3-3					
		0.5-5					
RPA-20JT		2-10	2.5-25 6-60 16-80 16-160	out Z3/4" out G3/4"	±4%	0-60	≤1
		2-16					
		2-20					
		3-13					
RPA-25JT		6-24	2.5-25 6-60 16-80 16-160	out Z1" out G1"	±4%	0-60	≤1
		10-35					
		10-45					
		30-170					



RPA-ZT



RPA-T



RPA-JT

The RPA-ZT series flowmeter is the same as the RPA-Z series (see page 26)

RPA-T series flowmeters have the same dimensions as RPA-Series flowmeters (see page 27)

RPA-JT series flowmeter has the same dimensions as RPA-J series flowmeter (see page 28)

Note: The standard material of regulating valve with regulating valve flowmeter is stainless steel 316

RPA Series Acrylic Flow Meter

RPA-G Series pipe type flowmeter technical parameters

Model	Range of measurement			Interface screw thread	Precision	Condition of the medium under test	
	GPM (liquid)	LPM (liquid)	Nm ³ /h(gas)			Tem °C	Pres Mpa
RPA-10G		2.5-25LPH	0.3-3	up hose Φ11.5 down out G1/2"	±4%	0-60	≤1
		5-45LPH					
		6-60LPH					
		10-100LPH					
		16-160LPH					
RPA-15GD		4-40LPH 10-100LPH	0.3-3	in G1/2"	±4%	0-60	≤1
RPA-15G	0.1-1	0.5-4	0.8-8 1-10				
RPA-15GF	0.2-2	1-7	1.6-16 2.5-25	in G3/4"	±4%	0-60	≤1
RPA-15GF	0.5-5	1.8-18	4-40				
RPA-20G	1.5-9	400-2000LPH	6-60	in G1"	±4%	0-60	≤1
RPA-20GF	1-10	4-36 100-1000LPH	6-60				
RPA-25G		1-10	6-60 10-100 ★15-140 16-160 25-250 35-350 80-400	in G1"	±4%	0-60	≤1
		1-15					
		2-20					
		5-30					
		5-40					
		5-45					
RPA-40G		1-10	6-60 10-100 ★15-140 16-160 25-250 35-350 80-400	out G1/2"	±4%	0-60	≤1
		1-15					
		2-20					
		5-30					
		5-40					
		5-45					
RPA-50G		20-60	100-500 120-600 300-850 400-1200 500-1400	in,out G2"	±4%	0-60	≤1
		1-10					
		1-15					
		2-20					
		5-30					
		5-40					
RPA-75GF		4-40	100-500 120-600 300-850 400-1200 500-1400	in G3"	±4%	0-60	≤1
		4-40					
		6-60					
		8-80					
		10-100					
		20-80					

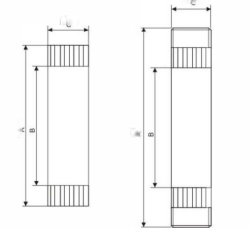

Internal thread connection External thread connection

RPA-G Series pipe type flowmeter dimensions

Model	Size (mm)		
	A	B	C
RPA-10G	187	130	22
RPA-15GD	180	150	32
RPA-15G	210	180	32
RPA-20G	278	236	45
RPA-25G	265	235	51
RPA-40G1	306	235	51
RPA-40G2	300	230	68
RPA-50G1	380	270	75
RPA-50G2	340	270	75
RPA-75GF	392	298	110x110

Note: In order to facilitate the use of users, this series of products have two kinds of circular and square structure, flow measurement range is the same "RPA-G" for circular pipe flowmeter "RPA-GF" for square pipe flowmeter

RPA-G Part selection of series surface plate flowmeter

Interface material	Material of float	O-ring material
<ol style="list-style-type: none"> 1. Plastic ABS 2. Plastic PP 3. Plastic PVC 4. Brass 5. Brass chrome plating 6. Stainless steel 	<ol style="list-style-type: none"> 1. Stainless steel 2. Agate ball 3. Teflon 	<ol style="list-style-type: none"> 1. Silicone ring 2. Fluorin rubber 3. Epdm rubber

RPA-15G The standard material for 20G connector is ABS

Note: Check √ material for meter gauge configuration

RPP-Durable Plastic Tube Type Flowmeter

RPP-Plastic pipe precision durable rotameter

RPP plastic pipe precision durable rotameter is a new product developed by our factory according to market needs. This product has obtained a patent certificate issued by the the People's Republic of China Patent Office. Patent number: ZL94208420.9

1. Takeover
2. Nut
3. "O" sealing ring
4. Top stop gear
5. Scale ruler
6. Cone
7. Float
8. Lower stop

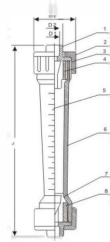

RPP-15-65 product structure drawing



Intubation connection

RPP-Plastic Pipe Precision Durable Rotameter Technical Parameters (Intubation Connection)

Model	Nominal diameter (DN)mm	Range of measurement		precision	Condition of the medium under test		Intubation connection size (mm)								Suitable pipe line Dg(mm)	Note
		Long tube type	Short tube type		Tem °C	Pres MPa	Long tube type				Short tube type					
RPP-15	15	10-100/h 16-160/h 25-250/h 40-400/h 50-500/h 60-600/h	5-50/h 10-100/h 16-160/h 25-250/h 40-400/h 50-500/h 60-600/h				L	D1	D2	D3	L	D1	D2	D3	15 or 20	Long pipe without guide bar (unless otherwise indicated) short pipe with guide bar
RPP-20	20		60-600/h 100-1000/h								231	25	35	45		
RPP-25	25	100-1000/h 160-1600/h 250-2500/h	4-40/m³/h 100-1000/h 180-1800/h 250-2500/h				380	32	39	68	226	32	39	60	25 or 32	
RPP-32	32		0.4-4m³/h 0.6-6m³/h	±4%	0-60	≤0.6					288	40	49.5	74	32 or 40	
RPP-40	40		0.4-4m³/h 0.6-6m³/h 1-10m³/h				430	50	63	88					40 or 50	
RPP-50	50		0.4-4m³/h 0.6-6m³/h 1-10m³/h 1.6-16m³/h				430	63	73	98	341	63	73	98	50 or 65	
RPP-65	65		2.5-16m³/h 5-25m³/h 8-40m³/h 12-60m³/h								430	75	88	122	65 or 75	

(Can provide Japanese standard, English standard intubation connection)

RPP- Plastic pipe Precision and durable rotor flowmeter parts Material Procurement Guide

Taper tube AS, nozzle (flange) nut, float for ABS, up and down stop PE LSS-C long tube type LSS-D short tube type

RPP-Durable Plastic Tube Type Flowmeter

RPP-Precision and durable rotor-flowmeter with plastic tubing

1. Takeover
2. Nuts
3. "O" sealing ring
4. Top stop gear
5. Scale ruler
6. Cone
7. Float
8. Lower stop

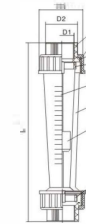

RPP-15-65 product structure drawing



Screw thread connection

RPP-Plastic tube precision durable rotor flowmeter technical parameters (threaded connection)

Model	Nominal diameter (Dn) mm	Range of measurement		precision	Condition of the medium under test		Intubation connection size (mm)								Suitable pipe line Dg (mm)	Note
		Long tube type	Short tube type		Tem °C	Pres MPa	Long tube type				Short tube type					
RPP-15	15	10-100/h 16-160/h 25-250/h 40-400/h 50-500/h 60-600/h	5-50/h 10-100/h 16-160/h 25-250/h 40-400/h 50-500/h 60-600/h				L	D1	D2	D3	L	D1	D2	D3	15	Long pipe has no guide bar and a short pipe has a guide bar
RPP-25	25	100-1000/h 160-1600/h 250-2500/h	100-1000/h 160-1600/h 250-2500/h				380	39	68	226	39	60	25			
RPP-32	32		0.4-4m³/h 0.6-6m³/h	±4%	0-60	≤0.6					288	49.5	74	32		
RPP-50	50		0.4-4m³/h 0.6-6m³/h 1-10m³/h 1.6-16m³/h				430	73	98	341	73	98	50			
RPP-65	65		2.5-16m³/h 5-25m³/h 8-40m³/h 12-60m³/h								430	88	122	65		

RPP- plastic pipe precision durable rotor flowmeter parts materials

Cone is AS, nozzle (flange) nut, float is ABS, up and down stop PE

RPP-Durable Plastic Tube Type Flowmeter

RPP-Plastic tube precision durable rotor flowmeter
 RPP plastic pipe precision and durable rotor flowmeter is a new product developed by our factory according to the market needs. The product obtained the patent certificate issued by the Patent Office of the People's Republic of China. Patent number: ZL94208420.9

1. Flange
2. "O" sealing ring
3. cone tube
4. the scale
5. Guide bar
6. Float



RPP - Plastic tube precision durable rotor flowmeter technical parameters (flange connection)

Model	Nominal diameter (DN) mm	Range of measurement		Precision	Condition of the medium under test			Flange connection dimensions (mm)								Suitable pipe line Dg(mm)	Note						
		Long tube type	Short tube type		T	°C	P	MPa	Long tube type				Short tube type										
RPP-15F	15	10-100l/h	5-50l/h	±4%	0-60	≤0.6	320								15	A long pipe has no guide bar and a short pipe has a guide bar							
		16-160l/h	16-160l/h				4-Φ14	65	95	241	4-Φ14	65	95										
25-250l/h	25-250l/h	470																					
40-400l/h	40-400l/h	320	4-Φ16				75	105	241	4-Φ16	75	105	20										
60-600l/h	60-600l/h	470																					
100-1000l/h	100-1000l/h	432																					
RPP-20F	20	16-160l/h	16-160l/h							4-Φ16								75	105	20			
		25-250l/h	25-250l/h				470																
RPP-25F	25	100-1000l/h	100-1000l/h							4-Φ16								85	115	25			
		160-1600l/h	160-1600l/h				470																
RPP-32F	32	0.4-4m³/h	0.4-4m³/h															355	4-Φ18	100	140		
		0.6-6m³/h	0.6-6m³/h				570	4-Φ18	110	150	500	4-Φ18	110	150			40						
RPP-40F	40	0.4-4m³/h	0.4-4m³/h												520	4-Φ18	125	165	50				
		0.6-6m³/h	0.6-6m³/h	570	4-Φ18	125	165	430	4-Φ18	125	165	50											
RPP-50F	50	0.4-4m³/h	0.4-4m³/h												570	4-Φ18	125	165	50				
		0.6-6m³/h	0.6-6m³/h																				
RPP-65F	65	2.5-16m³/h	2.5-16m³/h												530	4-Φ18	145	185	65				
		5-25m³/h	5-25m³/h												540	4-Φ18	180	215	100				
RPP-80F	80	8-40m³/h	8-40m³/h												560	8-Φ18	180	215	100				
		12-60m³/h	12-60m³/h												560	8-Φ18	210	250	125				
RPP-100F	100	14-90m³/h	14-90m³/h												560	8-Φ22	240	280	150				
		18-120m³/h	18-120m³/h												830	8-Φ22	295	340	200				
RPP-125F	125	20-150m³/h	20-150m³/h												830	12-Φ22	350	395	250				
		25-180m³/h	25-180m³/h												830	12-Φ22	400	445	300				
RPP-150F	150	25-200m³/h	25-200m³/h												830	12-Φ22	400	445	300				
		30-300m³/h	30-300m³/h																				
RPP-200F	200	30-350m³/h	30-350m³/h																				
		40-400m³/h	40-400m³/h																				

*F stands for flange connection (our company can provide US standard and Japanese standard flange connection)

RPP-Plastic pipe Precision and durable rotor flowmeter parts Material Procurement Guide

Taper tube is AS, nozzle (flange) nut, upper and lower stop, float is ABS LSS-C long tube type LSS-D short tube type

RPP-Durable Plastic Tube Type Flowmeter

RPP-E/G Plastic tube precision durable rotor flowmeter
 RPP-E/G series plastic pipe precision and durable rotor flowmeter is our factory to meet the market demand development of new products main components: taper pipe material for polycarbonate (PC) or polysulfone (PSU), the upper and lower connecting parts for polyvinyl chloride (PVC). Floats are made of stainless steel or ABS. Connection modes include intubation connection, internal and external thread connection and panel installation. RPP-E series taper tubes are made of polycarbonate (PC) and LZS-G series taper tubes are made of polysulfone (PSU).

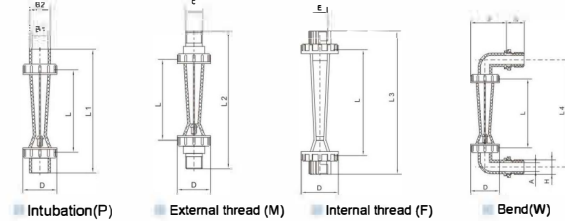

RPP-E/G Plastic tube precision durable rotor flowmeter technical parameters

Model	Nominal diameter	Range of measurement			Precision	Operating temperature (°C)	Working pressure		
		GPM	LPM	m³/h					
Rpp-15E	15	0.1-1	0.5-4	10-100l/h	±4%	0-60			
Rpp-15G		0.2-2	1-7	16-160l/h		0-100			
Rpp-15ED		0.5-5	1.8-18	60-600l/h		0-60			
Rpp-15GD	25	0.1-1	0.5-4	10-100l/h		0-100			
Rpp-15GC		0.2-2	1-7	25-250l/h		0-60			
Rpp-15GCG		0.5-5	1.8-18	40-400l/h		0-100			
Rpp-25E	25	0.8-8	3-30	0.25-2.5		±4%	0-60		
Rpp-25G		1-10	4-40	0.16-1.6			0-100		
Rpp-25E		1.2-12	5-50	0.1-1			0-60		
Rpp-32E	32	2-20	8-80	0.4-4			±4%	0-60	
Rpp-32G		2.5-25	10-100	0.6-6				0-100	
Rpp-50E		5-45	20-180	1-10				0-60	
Rpp-50G	50	7-70	25-250	1.6-16	±4%			0-100	
Rpp-65E		25-110	80-400	5-25				0-60	
Rpp-65G		40-160	150-650	8-40				0-100	
Rpp-65G	65	50-250	200-1000	12-60				±4%	0-100



DN15-DN50

RPP-E/G Plastic tube precision durable rotor flowmeter profile Mounting dimensions (mm)

Model	L	D	Intubation (P)			External thread (M)		Internal thread (F)		Bend (W)				
			L1	B1	B2	L2	C	L3	E	L4	F	G	A	H
Rpp-15E	170	Φ50	220	Φ20	Φ27.5	240	G1/2"	220	G1/2"	230	56	27	Φ13	G1/2"
Rpp-15G	170	Φ50	220	Φ20	Φ27.5	240	Z1/2"	220	Z1/2"	230	56	27	Φ13	Z1/2"
Rpp-15ED	100	Φ42	150	Φ20	Φ26	170	G1/2"	/	/	155	52	27	Φ13	G1/2"
Rpp-15GD	100	Φ42	150	Φ20	Φ26	170	Z1/2"	/	/	155	52	27	Φ13	Z1/2"
Rpp-15EC	160	Φ50	210	Φ20	Φ26	225	G1/2"	210	G1/2"	220	56	27	Φ13	G1/2"
Rpp-15GC	160	Φ50	210	Φ20	Φ26	225	Z1/2"	210	Z1/2"	220	56	27	Φ13	Z1/2"
Rpp-25E	170	Φ59	230	Φ32	Φ39	250	Z3/4"	225	G3/4"	270	70.5	28	Φ20	G3/4"
Rpp-25G	170	Φ59	230	Φ32	Φ39	250	Z3/4"	225	Z3/4"	270	70.5	28	Φ20	Z3/4"
Rpp-32E	225	Φ72	290	Φ40	Φ49	310	Z1"	290	G1"	345	86	35	Φ26	G1"
Rpp-32G	225	Φ72	290	Φ40	Φ49	310	Z1"	290	Z1"	345	86	35	Φ26	Z1"
Rpp-50E	290	Φ98	375	Φ63	Φ73	400	Z2"	370	Z2"	440	109	40	Φ45	G2"
Rpp-50G	290	Φ98	375	Φ63	Φ73	400	Z2"	370	Z2"	440	109	40	Φ45	Z2"
Rpp-65E	325	Φ120	420	Φ75	Φ89	445	Z2 1/2"	420	Z2 1/2"	/	/	/	/	/
Rpp-65G	325	Φ120	420	Φ75	Φ89	445	Z2 1/2"	420	Z2 1/2"	/	/	/	/	/

Note: Rpp-15E, Rpp-15G float with ABS plastic case, Rpp-15ED, Rpp-15GD, Rpp-15EC, Rpp-15GC float material with stainless steel 316.

RPP-Durable Plastic Tube Type Flowmeter

RPP-E/G Plastic pipe precision durable rotor flowmeter parts materials

Model	Intubation	External thread float	Internal thread	Bend	Float
RPP-15E(T) RPP-15G(T)	PVC	PA6s	/	PVC	316
RPP-15E(T) RPP-15G(T)	PVC	PA6s	PA66	PVC	316
RPP-25E RPP-25G	PVC	PA6s	PA66	PVC	ABS,304
RPP-32E RPP-32G	PVC	PA6s	PA66	PVC	ABS,304
RPP-50E RPP-50G	PVC	PA6s	PA66	PA6s	ABS,304
RPP-65E RPP-65G	PVC	PA6s	PA66	/	ABS

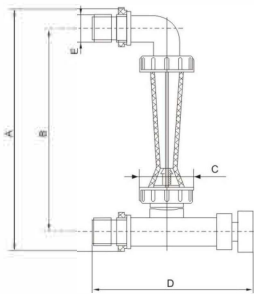

Precision durable rotor-flowmeter with plastic tube plate with regulating valve surface

RPP-ET/GT is equipped with a flow regulating valve on the basis of the small-caliber plastic pipe rotor flowmeter with elbow pipe, to control the flow size. The regulating valve material is acid and alkali resistant PVC. The main body of the cone is polycarbonate (PC) or polysulfone (PSU).

RPP-ET/GT Technical parameters of precision durable rotor flowmeter with adjustable valve surface plate plastic tube

Model	Nominal diameter	Range of measurement		Precision	Operating temperature (°C)	Working pressure	Size (mm)				
		GPM	LPM				A	B	C	D	E
RPP-15ET RPP-15GT	15	0.1-1 0.2-2 0.5-5	0.5-4	±4%	0-60°C	≤1MPa	187	157	Φ42	125	Z1/2" G1/2"
			1-7 1.8-18		0-100°C						
RPP-15ECT RPP-15GCT	15	0.1-1 0.2-2 0.5-5	0.5-4	±4%	0-60°C	≤1MPa	250	220	Φ50	125	Z1/2" G1/2"
			1-7 1.8-18		0-100°C						

RPC Series Plastic Tube Type Flowmeter

RPC- Series plastic pipe flowmeter

RPC series flowmeter is a kind of variable area flowmeter, its main material is polycarbonate (PC) or polysulfone (PSU), has the characteristics of high temperature and corrosion resistance. Since the float moves under the compression of a spring, the flowmeter can be placed at any Angle. At the same time, the red flow card mark is easy to use and identify. Working pressure: ≤1MPa Working temperature: polycarbonate: 0-80°C polysulfone: 0-120°C Accuracy: ±6%

RPC- Series of plastic tube flowmeter main technical parameters

Model	Range of measurement				Interface screw thread	Interface material
	20°C		101325pa20°C			
	GPM	LPM	GPM	LPS		
RPC 15 20 25	0.5-5	2-20	80-320 160-480 240-720 320-1100	5-20 10-30 15-45 20-70	ZG. Z. G1/2" (in,out) ZG. Z. G3/4" (in,out) ZG. Z. G1" (in,out)	Brass Stainless steel
	1-7	4-26				
	1-10	4-35				
	1-16	5-60				
	3-18	15-65				
RPC 40 50	4-28	20-100	250-1500 350-2200 450-4500	15-95 20-140 25-275	ZG. Z. G11/2" (in) ZG. Z. G2" (in) 2" Plastic pipe socket connection	Plastic PP Plastic PVC
	3-25	12-90				
	5-50	20-200				
	8-80	30-280				
	10-100	40-380				

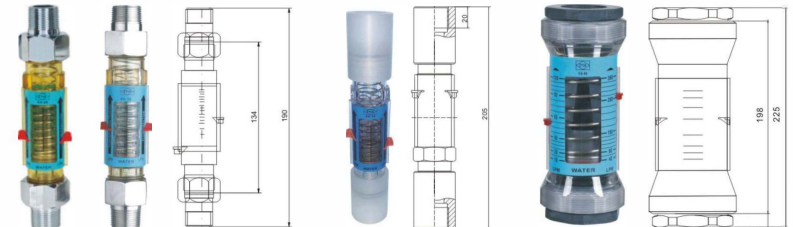

RPV Glass Tube Rotameter

RPV-4, 6, 10 F4-type glass rotor flowmeter

RPV-4, 6, 10F4 anti-corrosion glass rotor flowmeter, some on the market are made of stainless steel as a substitute material. It doesn't really act as a preservative. Therefore, our factory according to the market needs to develop a polytetrafluoroethylene as the main material anticorrosive flowmeter, at the same time to overcome the use of anticorrosive materials made of flow control valve this difficulty. Thus, the small diameter glass rotor flowmeter also has the anti-corrosion type. This product has good corrosion resistance to all kinds of strong acid (except hydrofluoric acid), strong base, oxidizing agent, strong oxidizing acid, organic solvent and other corrosive gas, liquid flow meter.

The patent number: 200520122839.3

RPV-4, 6, 10 F4-type glass rotor flowmeter technical parameters

Model	RPV-4 F4	RPV-6 F4	RPV-10 F4
Nominal diameter(mm)	Φ4	Φ6	Φ10
Range of measurement	liquid l/h	2.5-25	6-60
	gas Nm ³ /h	0.016-0.16	0.04-0.4
	liquid l/h	16-16	4-40
Precision(±%)	gas Nm ³ /h	0.025-0.25	0.06-0.6
	liquid l/h	0.04-0.4	0.1-1
	gas Nm ³ /h	0.04-0.4	0.1-1
Working pressure(MPa)	≤0.6	≤0.6	≤0.6
Operating temperature (°C)	0-80		

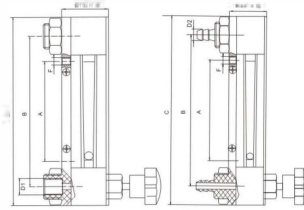

■ Screw thread connection ■ Hose connection

RPV-4, 6, 10 F4 Series anticorrosive rotor flowmeter appearance and mounting size

Model	Size (mm)					
	A	B	C	D1	D2	E
RPV-4F4	80	110	150	G1/4"	Φ9	37.5×34
RPV-6F4	80	110	150	G1/4"	Φ9	37.5×34
RPV-10F4	80	110	150	G1/4"	Φ9	37.5×34

RPV-4WB/6WB/10WB Series glass rotor flowmeter

RPV-WB type flowmeter is suitable for measuring the flow in a small range, the product has the characteristics of small volume, beautiful and lightweight.

RPV-4WB/6WB/10WB Series glass rotor flowmeter main technical parameters

Model	Range of measurement		Precision	Working pressure	Operating temperature (°C)
	Water l/min	Air l/min			
RPV-4WB	16-160ml/min	0.3-3	±4%	≤1MPa	0-60°C
	25-250ml/min	0.6-6			
RPV-6WB	0.04-0.4	0.7-7	±2.5%	≤1MPa	0-60°C
	0.06-0.6	1-10			
	0.1-1	1.5-15			
RPV-10WB	0.1-1	3-30	±2.5%	≤1MPa	0-60°C
	0.1-1	3-30			

WB type: flow meter with regulating valve, W type: without regulating valve.

RPV-4WB/6WB/10WB Series glass rotor flowmeter mounting size

Model	Size (mm)				
	A	B	C	D	E
RPV-4WB	26×25	90	116	136	Φ8
RPV-6WB	28×25	90	116	136	Φ11
RPV-10WB	28×25	90	140	160	Φ11

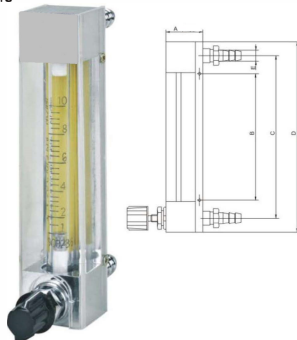

RPV Glass Tube Rotameter

RPV Series glass rotor flowmeter

The glass rotor flowmeter is used to measure the instantaneous flow of single phase non-pulsating liquid and gas in the pipeline. Mainly used in chemical industry, petroleum, medical, chemical fertilizer, food, sugar, paper, light industry, textile, printing and dyeing, environmental protection and other industrial departments and scientific research units. Anticorrosive glass rotor flowmeter mainly uses polytetrafluoroethylene advanced anticorrosive material in contact with the medium, which has good corrosion resistance to various strong acids (except hydrofluoric acid), strong alkali, oxidizing agent, strong oxidizing acid, organic solvent and other corrosive gases and liquid flow.

Model	RPV-3	RPV-4	RPV-6	RPV-10
Nominal diameter (mm)	Φ3	Φ4	Φ6	Φ10
Range of measurement	liquid l/h	2.5-25ml/min	1-10	★1-10
	gas Nm ³ /h	4-40ml/min	1.6-16	★100-800ml/min
	liquid l/h	6-60ml/min	2.5-25	★2.5-25
	gas Nm ³ /h	★10-80ml/min	2.5-25	4-40
	liquid l/h	10-100ml/min	★3.6-36	6-60
	gas Nm ³ /h	★0.3-3l/h		
Precision(±%)	liquid l/h	0.03-0.3l/min	★0.2-2.5l/min	0.04-0.4
	gas Nm ³ /h	0.06-0.6l/min	★0.16-1.6	0.16-1.6
	liquid l/h	0.1-1l/min	0.016-0.16	0.06-0.6
	gas Nm ³ /h	0.15-1.5l/min	0.025-0.25	★1-10l/min
	liquid l/h	★0-100l/h	0.04-0.4	0.1-1
Working pressure (MPa)	4, 6	2.5, 4	2.5	2.5
Operating temperature (°C)	0-60			

Note: The flow of "★" is a special flow developed by our company

Nominal diameter ≤10mm stainless steel flowmeter, base material is SS304 stainless steel, sealing material is fluorine rubber.

RPV-3, 4, 6, 10 Shape and mounting size (including F, S and B)

Model	Size (mm)					
	A	B	C	D	E	F
RPV-3		116	136	Φ8	26×25	
RPV-4	178	204	234	Φ9	39.5×34	2-M6
RPV-6	178	204	234	Φ9	39.5×34	2-M6
RPV-10	178	208	238	Φ12	39.5×34	2-M6

RPV-4G, 6G, 10G Pipe type flowmeter dimensions (mm)

Model	Thread connection size				Hose connection size		
	L	a×b	C	D	L1	a×b	G
RPV-4G	198	12×123	Φ35	G1/4"	240	12×123	Φ8
RPV-6G	198	14×123	Φ35	G1/2"	240	14×123	Φ11

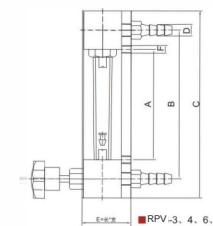

■ RPV-3, 4, 6, 10

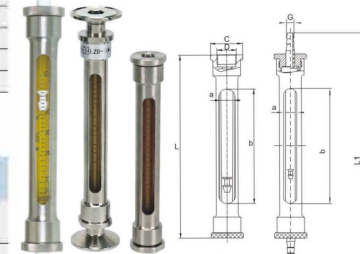

■ RPV-4G, 6G, 10G

SINTEK

RPV-ordinary series glass rotor flowmeter technical parameters

Model	RPV-15	RPV-25	RPV-40	RPV-50	RPV-80	RPV-100	RPV-100
Nominal diameter (mm)	φ15	φ25	φ40	φ50	φ80	φ100	φ100
liquid l/h	★6-60	40-400	160-1600	★160-1600	1-10 m³/h	5-25 m³/h	★20-90 m³/h
	★8-80	60-600	★180-1800	400-4000	1.6-16 m³/h	★6-35 m³/h	★20-100 m³/h
	16-160	100-1000	250-2500	600-6000	★2-20 m³/h	8-40 m³/h	★30-100 m³/h
	25-250	★160-1600	★300-3000	★800-8000	★3-25 m³/h	★12-60 m³/h	★50-120 m³/h
40-400		★400-4000	★1-10 m³/h	★8-40 m³/h	★16-80 m³/h		
			★1.5 m³/h	★4-16 m³/h			
		★1.5-6 m³/h					
gas Nm³/h	0.25-2.5	★0.8-8	4-40	★6-60	50-250	★60-200	★300-1500
	0.4-4	1-10	★5-50	10-100	80-400	★80-400	★300-1600
	0.6-6	1.6-16	6-60	16-160	★750-7500/min	★100-500	★400-2000
	★0.8-8	2.5-25	★7-70	★20-200	★60-600	120-600	★500-2500
★1-10	★3-30	★8-80	★30-300		200-1000		
	★4-40	★10-100	★50-250				
			★80-400				
Precision(±%)	2.5	1.5	1.5	1.5	1.5	1.5	1.5
Working pressure(MPa)	≤0.6	≤0.6	≤0.6	≤0.6	≤0.4	≤0.4	≤0.4
Operating temperature(°C)	0-60						



RPV-F Anti-corrosion glass rotor flowmeter technical parameters

Model	RPV-15F	RPV-25F	RPV-40F	RPV-50F	RPV-80F	RPV-100F
Nominal diameter (mm)	φ15	φ25	φ40	φ50	φ80	φ100
liquid l/h	16-160	40-400	160-1600	400-4000	1-10 m³/h	5-25 m³/h
	25-250	60-600	250-2500	600-6000	1.6-16 m³/h	8-40 m³/h
	40-400	100-1000				
gas Nm³/h	0.25-2.5	1-10	4-40	10-100	50-250	120-600
	0.4-4	1.6-16	6-60	16-160	80-400	200-1000
	0.6-6	2.5-25				
Precision(±%)	4	2.5	2.5	2.5	2.5	2.5
Working pressure(MPa)	≤0.6	≤0.6	≤0.6	≤0.6	≤0.4	≤0.4
Operating temperature(°C)	-20-120					



RPV-S Water phenotype glass rotor flowmeter technical parameters

Model	RPV-10S	RPV-15S	RPV-25S	RPV-40S	RPV-50S	RPV-80S
(mm)	10	15	25	40	50	80
Range of measurement l/h	10-100	2-70	100-400	120-1500	450-7000	1.5-15 m³/h
		2-90	70-700	200-2000	450-8000	2-20 m³/h
		4-90	100-700	300-1750	700-7000	7-30 m³/h
		6-105				7-31.5 m³/h
	1.5	1.5	1.5	1.5	1.5	1.5
	≤1.0	≤0.6	≤0.6	≤0.6	≤0.6	≤0.4
	0-60					



SINTEK

RPV-B All stainless steel series glass rotor flowmeter technical parameters

Model	RPV-15B	RPV-25B	RPV-40B	RPV-50B	RPV-80B	RPV-100B	RPV-100B
Nominal diameter (mm)	φ15	φ25	φ40	φ50	φ80	φ100	φ100
liquid l/h	★6-60	40-400	160-1600	★160-1600	1-10 m³/h	5-25 m³/h	★20-90 m³/h
	★8-80	60-600	★180-1800	400-4000	1.6-16 m³/h	★6-35 m³/h	★20-100 m³/h
	16-160	100-1000	250-2500	600-6000	★2-20 m³/h	8-40 m³/h	★30-100 m³/h
	25-250	★160-1600	★300-3000	★800-8000	★3-25 m³/h	★12-60 m³/h	★50-120 m³/h
40-400		★400-4000	★1-10 m³/h	★8-40 m³/h	★16-80 m³/h		
			★1.5 m³/h	★4-16 m³/h			
		★1.5-6 m³/h					
gas Nm³/h	0.25-2.5	★0.8-8	4-40	★6-60	50-250	★60-200	★300-1500
	0.4-4	1-10	★5-50	10-100	80-400	★80-400	★300-1600
	0.6-6	1.6-16	6-60	16-160	★750-7500/min	★100-500	★400-2000
	★0.8-8	2.5-25	★7-70	★20-200	★60-600	120-600	★500-2500
★1-10	★3-30	★8-80	★30-300		200-1000		
	★4-40	★10-100	★50-250				
			★80-400				
Precision(±%)	2.5	1.5	1.5	1.5	1.5	1.5	1.5
Working pressure(MPa)	≤0.6	≤0.6	≤0.6	≤0.6	≤0.4	≤0.4	≤0.4
Operating temperature(°C)	-20-120						

Note: The flow of "★" is a special flow developed by our company



RPV-BF All stainless steel anti-corrosion series glass rotor flowmeter

Model	RPV-15BF	RPV-25BF	RPV-40BF	RPV-50BF	RPC-80BF	RPV-100BF
Nominal diameter (mm)	φ15	φ25	φ40	φ50	φ80	φ100
liquid l/h	16-160	40-400	160-1600	400-4000	1-10 m³/h	5-25 m³/h
	25-250	60-600	250-2500	600-6000	1.6-16 m³/h	8-40 m³/h
	40-400	100-1000				
gas Nm³/h	0.25-2.5	1-10	4-40	10-100	50-250	120-600
	0.4-4	1.6-16	6-60	16-160	80-400	200-1000
	0.6-6	2.5-25				
Precision(±%)		2.5	2.5	2.5	2.5	2.5
Working pressure(MPa)	≤0.6	≤0.6	≤0.6	≤0.6	≤0.4	≤0.4
Operating temperature(°C)	-20-120					

SS304 stainless steel base produced by our company adopts precision welding process, which can effectively avoid the defects caused by the casting base, both from the appearance and performance have been improved.



RPV-Series Glass rotor flowmeter Appearance and mounting Dimensions (general)

Model	Size (mm)				
	A	B	C	D	n-E
RPV-15	φ95	φ65	470±2.5	φ15	4-φ14
RPV-25	φ115	φ85	470±2.5	φ25	4-φ14
RPV-40	φ145	φ110	570±3	φ40	4-φ18
RPV-50	φ160	φ125	570±3	φ50	4-φ18
RPV-80	φ185	φ150	660±3.5	φ80	4-φ18
RPV-100	φ205	φ170	660±3.5	φ100	4-φ18

Note: RPV-15 has no guide bar

